



- LEGEND**
- DPO boundary
 - Clusters site boundary
 - West Maddingley Development Plan - Part 3 Further investigation area
 - Indicative lot layout (subject to finalisation at detailed design stage)
 - Access streets (indicative alignments)
 - Collector streets (indicative alignments)
 - Arterial roads (indicative alignments)
 - Large lot residential (but not excluding applications for conventional and medium density residential)
 - Conventional residential (but not excluding applications for medium density residential)
 - Integrated Development Site (subject to separate planning approval)
 - School & community
 - Activity centre
 - Existing homestead & surrounds
 - Public open space
 - Buloke conservation area
 - Native Grassland
 - Existing trees to be retained
 - Drainage / waterways

MOORABOOL PLANNING SCHEME
 Development Plan Approval in accordance with
 Clause 43.04 of the
 Moorabool Planning Scheme.
 I certify that this document forms part of the endorsed
 Development Plan approved by resolution of Council
 on the 20 July 2011.
 PLAN ONE OF THREE
 Signature for the Responsible Authority
 Date 9 Aug 11



Scale: 1:4000 @ A1
 1:8000 @ A3
 02/08/2011

please note:
 This plan is based on preliminary information
 only and may be subject to change as a result
 of formal Council/Authority advice, detailed site
 investigations and confirmation by survey

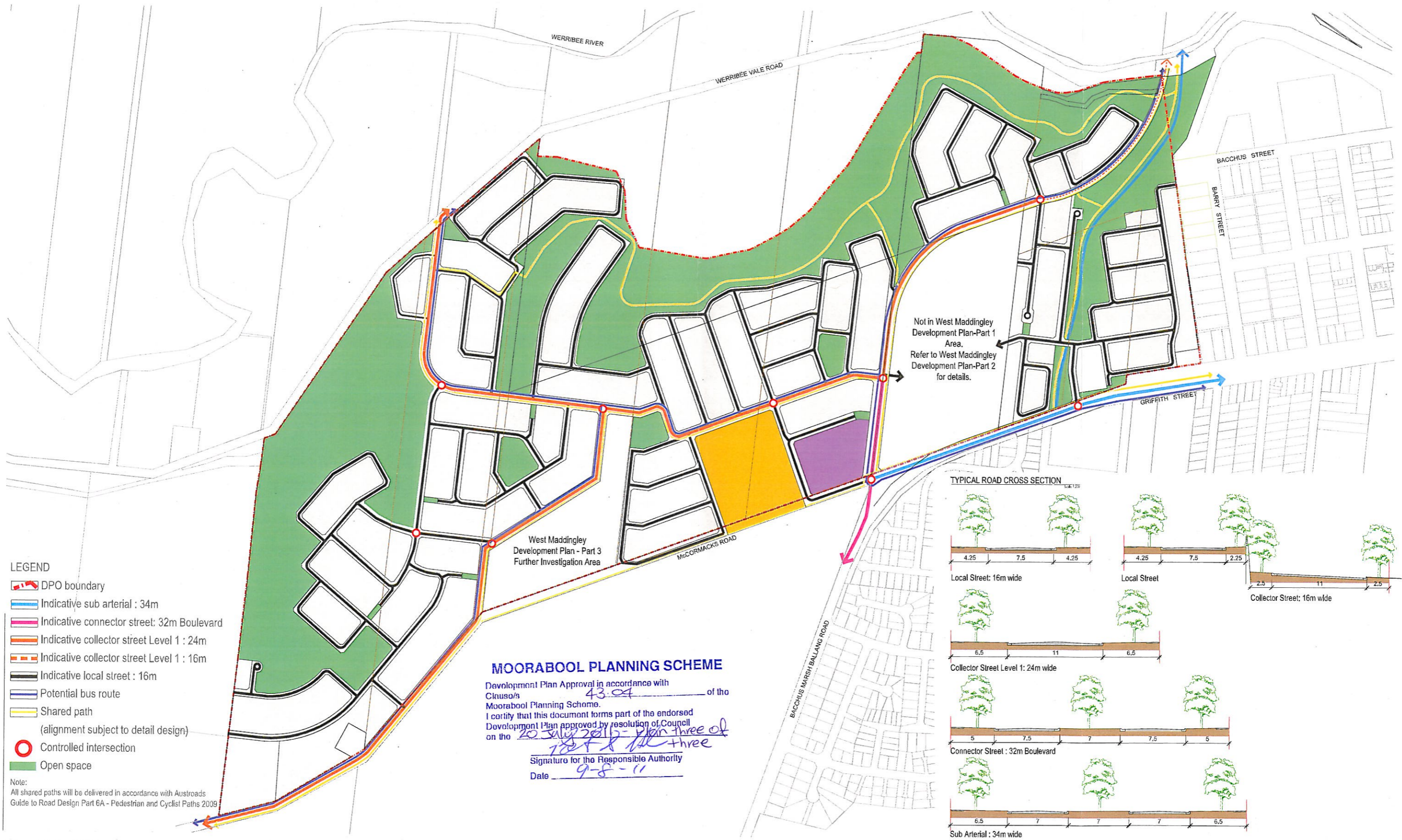

LEGEND

- DPO boundary
- Indicative sub arterial : 34m
- Indicative connector street: 32m Boulevard
- Indicative collector street Level 1 : 24m
- Indicative collector street Level 1 : 16m
- Indicative local street : 16m
- Potential bus route
- Shared path
(alignment subject to detail design)
- Controlled intersection
- Open space

Note:
All shared paths will be delivered in accordance with Austroads
Guide to Road Design Part 6A - Pedestrian and Cyclist Paths 2009

MOORABOOL PLANNING SCHEME

Development Plan Approval in accordance with
Clasos/s 43.04 of the
Moorabool Planning Scheme.
I certify that this document forms part of the endorsed
Development Plan approved by resolution of Council
on the 20 July 2011 - Plan three of
187 & 188 three
Signature for the Responsible Authority
Date 9-8-11

Not in West Maddingley
Development Plan-Part 1
Area.
Refer to West Maddingley
Development Plan-Part 2
for details.

TYPICAL ROAD CROSS SECTION

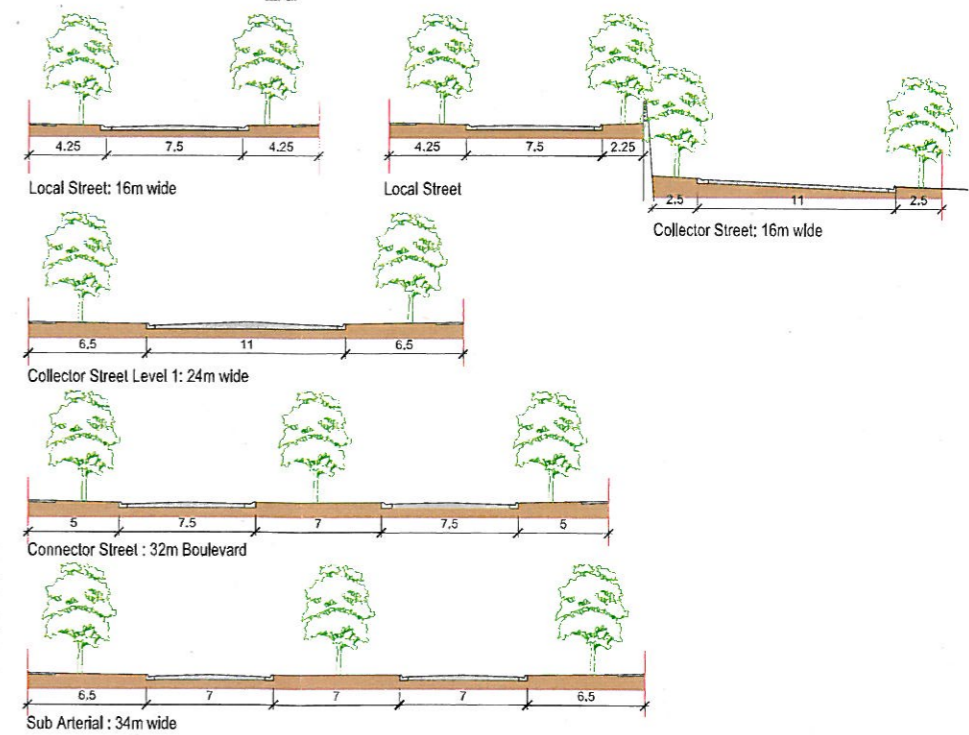

Road Hierarchy and Movement Plan
Stonehill, Bacchus Marsh

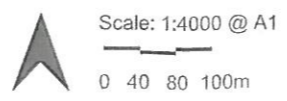

please note:
This plan is based on preliminary information
only and may be subject to change as a result
of formal Council/Authority advice, detailed site
investigations and confirmation by survey

ref: 3410587P
date: 9 Aug 2011
rev.: 1
drawn: DM
checked: CD

planning & urban design
melbourne - tel 9869 0800
© smec australia Pty Ltd
abn 47 065 475 149
trading as smec urban

